



TOUCH II

User friendly and totally programmable 7" Touch II USB Connection. Online platform free of charge for programming, telemetry, data analysis...thanks to the IoT
Videos on display (ads, instructions, etc.)
37 languages



OUTSTANDING FEATURES

Reversing drum action as standard
Stainless steel drum as standard
Frequency inverter as standard.



EFFICIENCY

DOUBLE FLOW - mixed axial-radial airflow
New TURBO gas heated model: more power to achieve more productivity.



VERSATILITY

Make to order - customisation
WET CLEANING
OPL > Multivending - Standard OPL model easily trasformable to coin laundry uses



CONNECTIVITY

IoT-Domus Connect Standard
Management of laundries: OPL and COIN
Remote payment (coin-laundry)



ERGONOMICS

Drawer as fluff filter, stainless steel mesh
Biggest door diameters



MAINTENANCE

Hinged control panel: easy and ergonomic access
Technical menu: statistics for technicians and maintenance with external console (with console option)



OTHERS

Grey skinplate outer casing, stainless steel look
SOFT DRY - new drum with stamped holes
COOL DOWN - anti-wrinkle at the end of the cycle
CE approved



OPTIONS

- EFFICIENT DRY - Intelligent humidity control. Temperature probe at drum inlet.
- Double door glass
- SFEX - Integrated Fire Extinguishing System
- Tropicalized model
- Opposite door opening
- Dosing-spraying
- Back panel external air + filter
- Fluff filter with grid 0,3 mm (standard in STACK is 0,6mm)
- Stainless steel front and side panels
- Frontal panel in stainless steel
- Maritime wooden packing
- Ship voltage for electric models: 440V III 50/60 Hz No neutral
- Other voltages available

| TECHNICAL DATA | UNIT. | DTT2-TURBO | |
|--|--------------|-------------------|---------------|
| CAPACITY | | | |
| Capacity 1/18 | Kg | 37 | |
| Capacity 1/20 | Kg | 33 | |
| Hourly Output (gas)* | Kg/h | 70,7 | |
| Evaporation capacity (gas)* | l/h | 35,3 | |
| DRUM | | | |
| Ø Drum | mm | 750 | |
| Ø Door | mm | 574 | |
| Door center height | mm | 547 / 1.522 | |
| Load hole bottom height | mm | 260 / 1.235 | |
| Drum length | mm | 746 | |
| Drum volume | l | 330 | |
| POWER | | | |
| Drum motor power | kW | 0,37x2 | |
| Fan motor power | kW | 0,55x2 | |
| Electric heating power | kW | - | |
| Total electric power (elec.model) | kW | - | |
| Gas heating power | kW | 24x2 | |
| Instant propane gas consumption (G31) | kg/h | 2,06 X 2 | |
| Instant natural gas consumption (G20) | m3/h | 2,54 X 2 | |
| Total electric power (gas model) | kW | 1,94 | |
| CONNECTIONS | | ELECTRICAL | GAS |
| Tension 230V - I + N + T | Nº x mm2 / A | - | 3 x 1,5 / 20A |
| Tension 230V - III + T | Nº x mm2 / A | 4 x 25 / 80A | 3 x 1,5 / 20A |
| Tension 400V - III + N + T | Nº x mm2 / A | 5 x 10 / 40 | 3 x 1,5 / 20A |
| Ø Gas inlet | BSP | 1/2" | |
| DIMENSIONS / PACKING DIMENSIONS | | | |
| Net width / Gross width | mm | 785 / 865 | |
| Net Depth / Gross Depth | mm | 1443 / 1457 | |
| Net Height / Gross Height | mm | 1980 / 2126 | |
| Net weight / Gross weight | Kg | 320 / 349 | |
| OTHERS | | | |
| Max airflow | m3/h | 750 x 2 | |
| Ø Fume exhaust | mm | 200 x 2 | |
| Sound level | dB | 64 | |

* It may vary depending on the type of heating, filter cleanliness or extraction type.

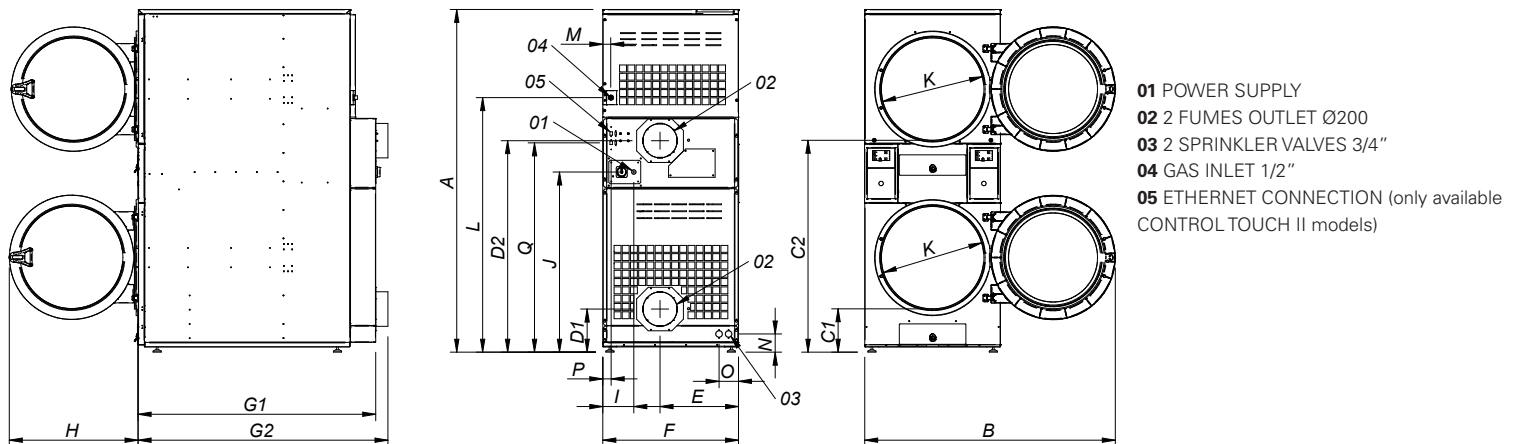

| | A | B | C1 | C2 | D1 | D2 | E | F | G1 | G2 | H | I | J | K | L | M | N | O | P | Q |
|---------------|-------|------|-----|------|-----|------|-----|-----|------|------|-----|-----|------|-----|------|----|-----|-----|----|------|
| DTT2-18 TURBO | 1980* | 1447 | 259 | 1234 | 250 | 1223 | 454 | 785 | 1374 | 1443 | 735 | 180 | 1040 | 575 | 1472 | 45 | 103 | 100 | 49 | 1210 |

* Measurement with legs mounted (30mm)